

ISO STANDARD CHAINS - **MC112**

Dimensions in mm

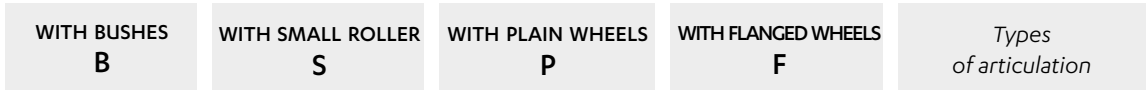
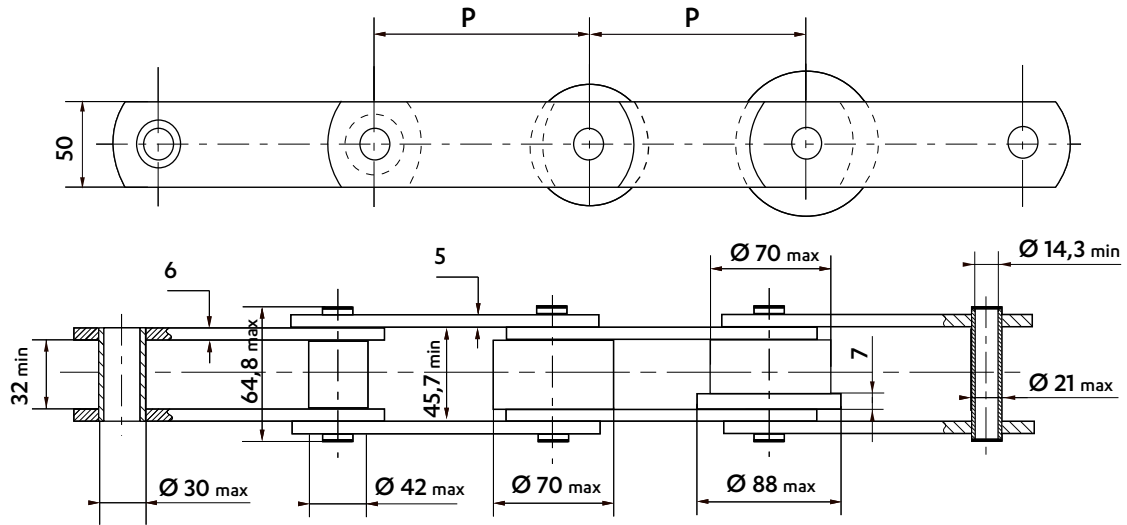

Wheels in different materials can be supplied.

WELDED K1 & K2 ATTACHMENTS - 60 X 60 X 6

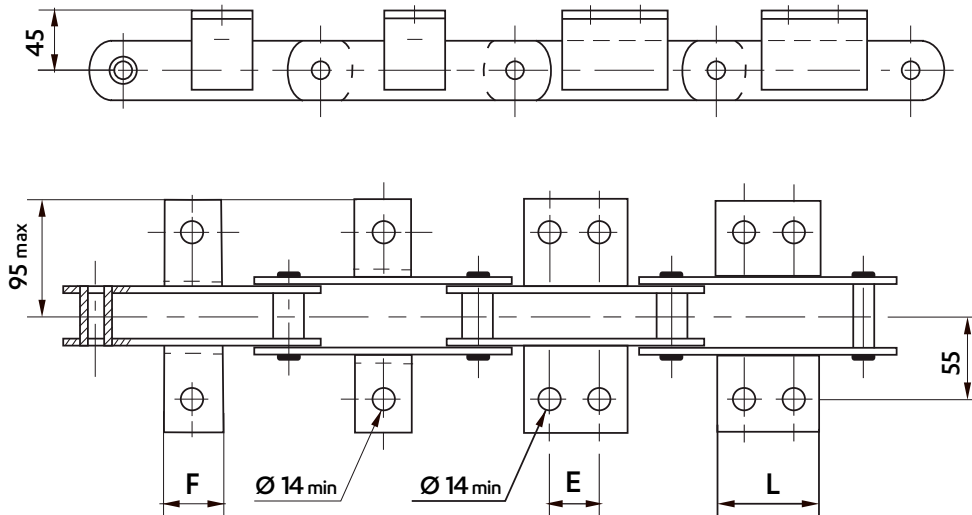

Frequency of attachments on request : on one or both sides of the chain, on inner and/or outer links

Pitch	Attachment dimensions (mm)							Weight of the chain (Kg/m)				Weight of the attachment (Kg/piece)				
	K1		K2C		K2M		K2L		Bush (B)	Roller (S)	Plain wheel (P)	Flanged wheel (F)	K1	K2C	K2M	K2L
	F	E	L	E	L	E	L									
100	◆	◆	◆	◆	◆	◆	◆	9,2	10,6	-	-	-	-	-	-	-
125	40	◆	◆	◆	◆	◆	◆	8,3	9,4	15,5	16,3	-	-	-	-	-
160	40	50	85	◆	◆	◆	◆	7,5	8,4	13,2	13,8	-	-	-	-	-
200	40	50	85	85	120	◆	◆	7,0	7,7	11,6	12,1	0,19	-	-	-	-
250	40	50	85	85	120	145	180	6,6	7,1	10,2	10,6	0,19	0,46	-	-	-
315	40	50	85	85	120	145	180	6,2	6,7	9,1	9,4	0,19	0,46	0,65	0,97	-

◆ Not standard : possible to make on request.

Dimensions in mm

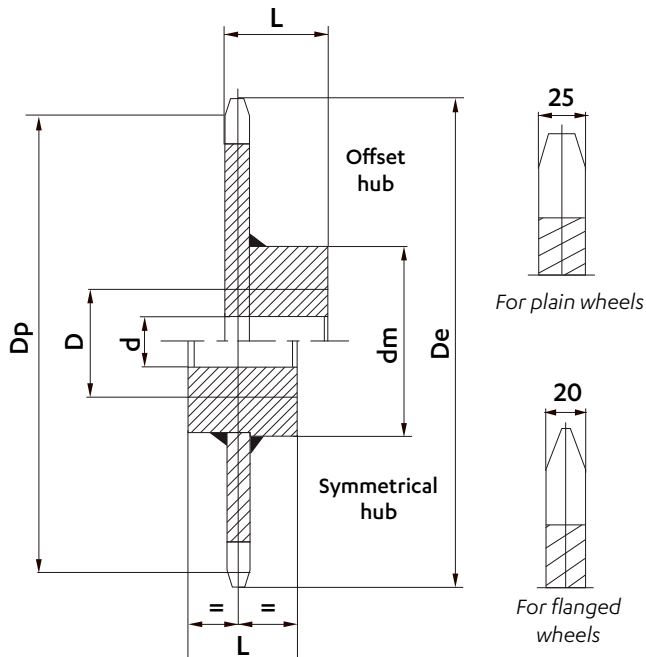
STANDARD CHAIN WHEELS

Sedis wheels are supplied made of machine-welded steel or of cast iron in some cases. Teeth are raw casting or flame-cut, or machined for bush chains. Wheels can be supplied bored and keyed. For wheels with offset hub, the entry point of the key is placed at the same side as the teeth, unless specified otherwise.

We can make on request:

- wheels with machined teeth
- wheels with a different number of teeth
- special wheels

Pitch	Number of teeth	Dimensions (mm)						Weight (kg/p)
		D_p	D_e	d	D	D_m	L	
125	8	326,63	346	30	80	150	80	
	10	404,51	424	30	100	170	100	35
	12	482,96	506	30	100	170	100	39
160	16	640,72	664	40	120	200	120	64
	8	418,09	438	30	100	170	100	39
	10	517,77	540	30	100	170	100	42
	12	618,19	640	40	120	200	120	60
200	16	820,12	844	40	120	200	120	80
	8	522,62	542	30	100	170	100	43
	10	647,22	668	40	120	200	120	58
	12	772,74	794	40	120	200	120	76
250	16	1025,16	1048	40	140	240	140	115
	8	653,27	670	40	120	200	120	64
	10	809,02	830	40	120	200	120	79
	12	965,92	988	40	140	240	140	109
16	1281,45	1304	40	140	240	140	153	

Despatch possible within 2 weeks

CONNECTING LINKS

REF N° 205
Outer link to be riveted

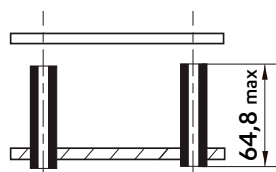
DRILLED PLATES

All drilled plates on request