

# BS STANDARD CHAINS - M100

Dimensions in mm

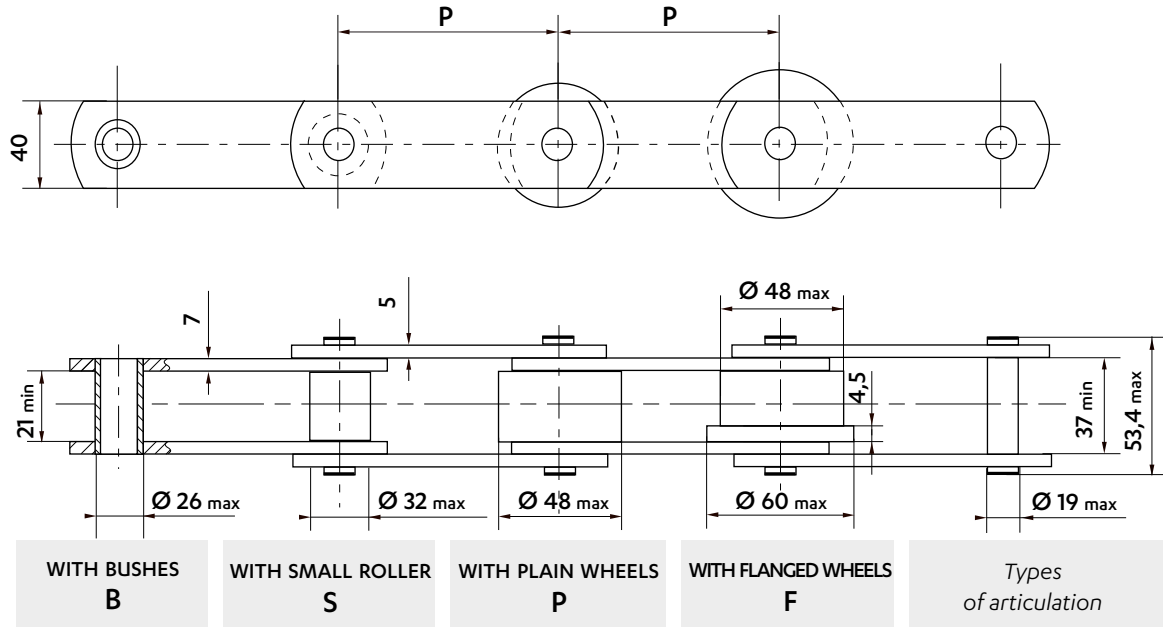

Wheels in different materials can be supplied.

## WELDED K1 & K2 ATTACHMENTS - 50 X 50 X 5

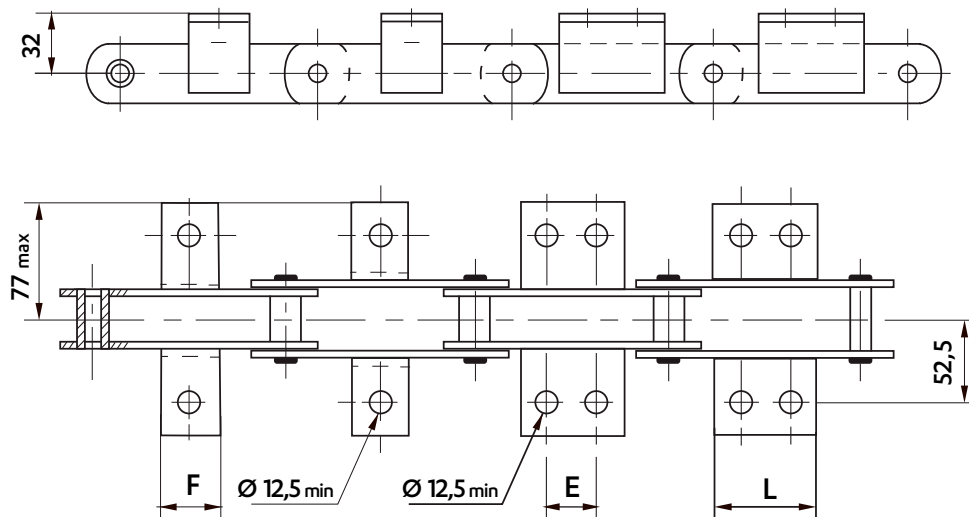

Frequency of attachments on request : on one or both sides of the chain, on inner and/or outer links

Pitch	Attachment dimensions (mm)								Weight of the chain (Kg/m)				Weight of the attachment (Kg/piece)			
	K1		K2C		K2M		K2L		Bush (B)	Roller (S)	Plain wheel (P)	Flanged wheel (F)	K1	K2C	K2M	K2L
75	◆	◆	◆	◆	◆	◆	◆	8,5	9,1	11,1	-					
76,2	◆	◆	◆	◆	◆	◆	◆	8,5	9,0	11,1	11,7					
88,9	◆	◆	◆	◆	◆	◆	◆	8,1	8,6	10,3	10,8					
100 *	45	◆	◆	◆	◆	◆	◆	7,7	8,1	9,7	10,1					
101,6 *	45	◆	◆	◆	◆	◆	◆	7,6	8,0	9,5	10,0	0,18	0,18	0,21	0,21	
125	45	32	55	◆	◆	◆	◆	6,9	7,2	8,5	8,9					
127	45	32	55	◆	◆	◆	◆	6,9	7,2	8,4	8,8					
150	45	32	55	58	85	◆	◆	6,4	6,7	7,7	8,0					
152,4	45	32	55	58	85	◆	◆	6,4	6,7	7,7	8,0					
200	45	32	55	58	85	90	118	5,8	6,0	6,8	6,9					

◆ Not standard : possible to make on request. \* These pitches allow mounting of K2 attachments only on outer links

Intermediate pitches are on request

Dimensions in mm

## STANDARD CHAIN WHEELS

Sedis wheels are supplied made of machine-welded steel or of cast iron in some cases.

Teeth are raw casting or flame-cut, or machined for bush chains.

Wheels can be supplied bored and keyed.

For wheels with offset hub, the entry point of the key is placed at the same side as the teeth, unless specified otherwise.

We can make on request:

- wheels with machined teeth
- wheels with a different number of teeth
- special wheels

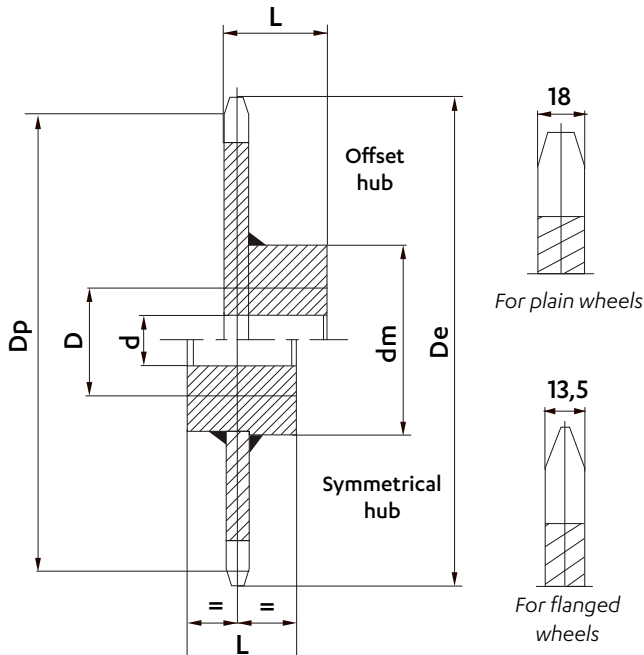

Pitch	Number of teeth	Dimensions (mm)						Weight (kg/p)
		Dp	De	d	D	Dm	L	
75	8	195,98	217	25	50	100	50	7
	10	242,71	264	30	60	115	65	9
	12	289,78	311	30	60	115	65	14
76,2	8	199,12	220	25	50	100	50	7
	10	246,59	267	30	60	115	65	9
88,9	12	294,41	315	30	60	115	65	14
	8	232,31	253	25	50	100	50	9
	10	287,69	308	30	60	115	65	12
100	12	343,48	364	30	60	115	65	17
	8	261,31	282	30	60	120	80	11
	10	323,61	344	30	60	120	80	15
101,6	12	386,37	407	30	70	120	80	20
	8	265,49	286	30	60	115	65	11
	10	328,78	350	30	60	115	65	15
125	12	392,55	413	30	70	120	80	20
	8	326,64	347	30	60	120	80	16
	10	404,51	425	30	60	120	80	22
127	12	482,96	504	30	70	120	80	29
	8	331,87	353	30	60	120	80	16
	10	410,98	432	30	60	120	80	22
150	12	490,69	511	30	70	120	80	29
	8	391,97	413	30	70	120	80	22
	10	485,41	506	30	70	120	80	30
152,4	12	579,56	600	40	70	120	80	39
	8	398,24	419	30	70	120	80	22
	10	493,18	514	30	70	120	80	30
200	12	588,83	610	30	70	120	80	39
	8	522,63	544	30	70	120	8	34
	10	647,21	668	30	70	120	80	44
250	12	772,74	794	30	70	120	80	55
	CONSULT US							

## CONNECTING LINKS

REF N° 208  
Cottered connecting link

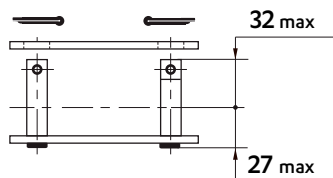

REF N° 209  
Connecting link with self-locking nuts

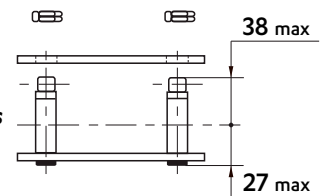

## DRILLED PLATES

On outer and inner plates

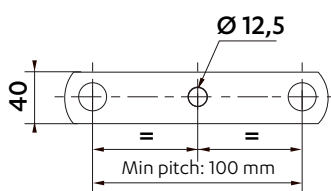

1 HOLE

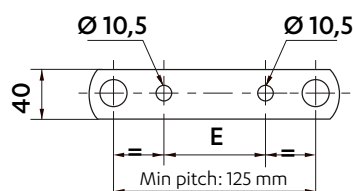

2 HOLES

125mm pitch : E = 35 mm  
150mm pitch : E = 60 mm  
160mm pitch : E = 80 mm

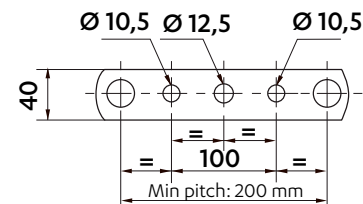

3 HOLES