

ISO STANDARD CHAINS 1977 - **M315**

Dimensions in mm

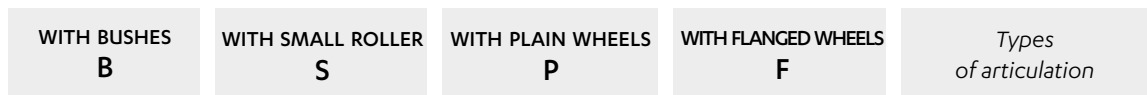
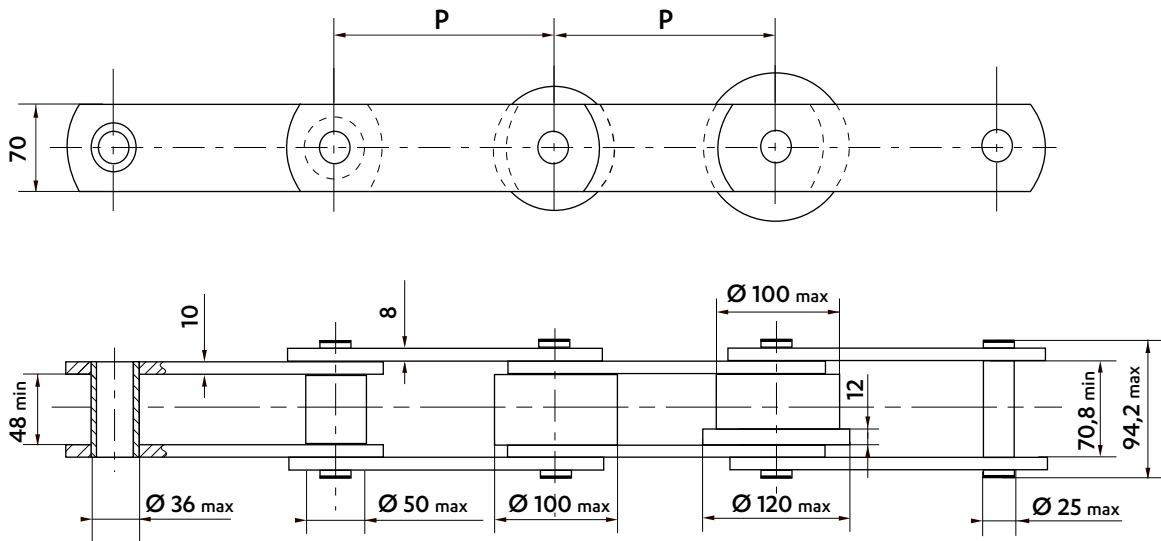

Wheels in different materials can be supplied.

WELDED K1 & K2 ATTACHMENTS - 90 X 70 X 8

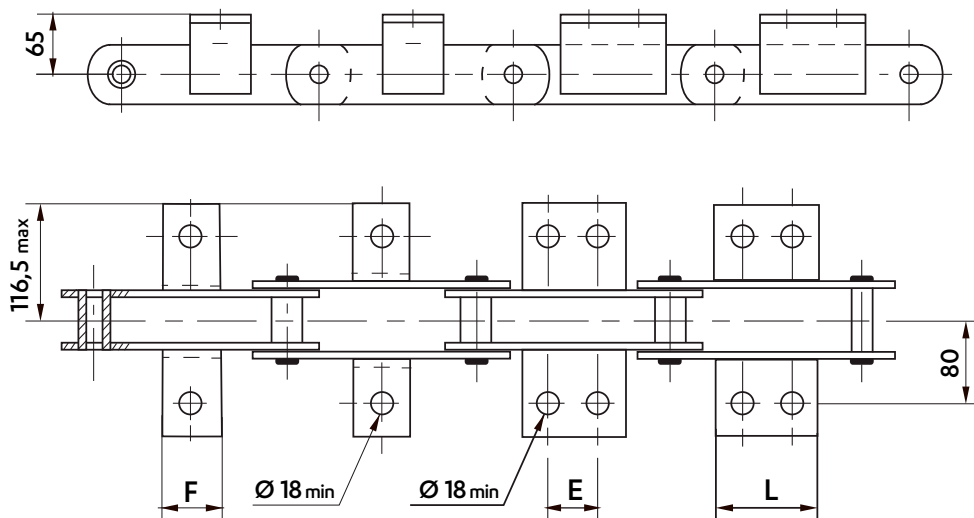

Frequency of attachments on request : on one or both sides of the chain, on inner and/or outer links

Pitch	Attachment dimensions (mm)							Weight of the chain (Kg/m)				Weight of the attachment (Kg/piece)			
	K1		K2C		K2M		K2L	Bush (B)	Roller (S)	Plain wheel (P)	Flanged wheel (F)	K1	K2C	K2M	K2L
	F	E	L	E	L	E	L								
160	60	◆		◆		◆		17,3	19,4	-	-				
200	60	50	100	◆		◆		15,7	17,4	28,0	30,0				
250	60	50	100	100	150	155	205	14,6	16,0	24,4	26,0				
315	60	50	100	100	150	155	205	13,5	14,6	21,3	22,6	0,42	0,74	1,11	1,52
400	60	50	100	100	150	155	205	12,7	13,5	18,8	19,8				
500	60	50	100	100	150	155	205	12,0	12,7	17,0	17,8				
630	60	50	100	100	150	155	205	11,6	12,1	15,4	16,1				

◆ Not standard : possible to make on request.

Intermediate pitches are on request

Dimensions in mm

WELDED G ATTACHMENTS

Pitch	l3	b2	b14	l2	d11	e	h5	Weight (kg/p)
160	70			40				0,99
200	90	140	100	55	15	10	73	1,30
250	110			70				1,56

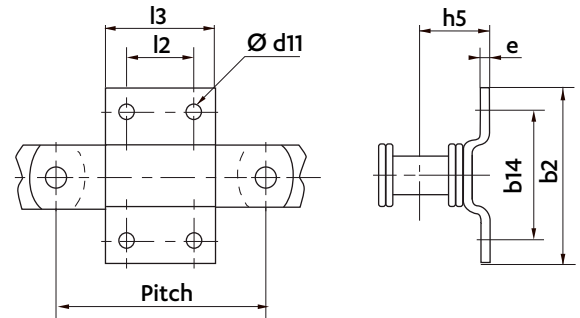
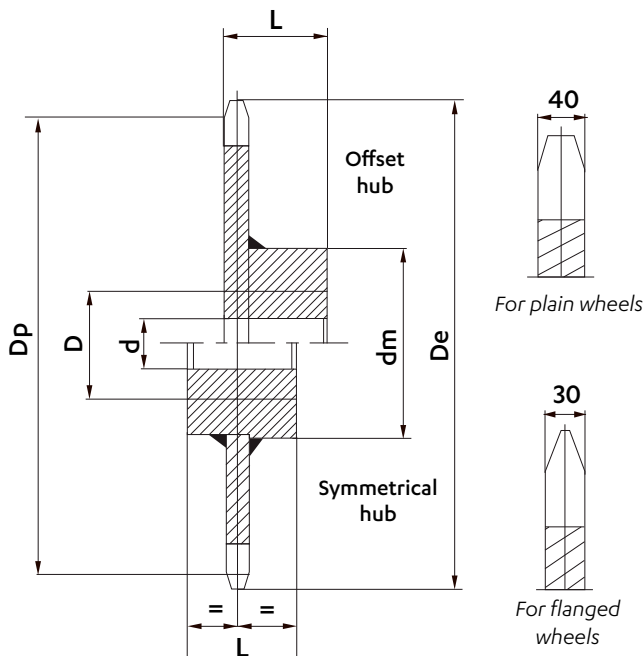
STANDARD CHAIN WHEELS

Sedis wheels are supplied made of machine-welded steel or of cast iron in some cases. Teeth are raw casting or flame-cut, or machined for bush chains. Wheels can be supplied bored and keyed. For wheels with offset hub, the entry point of the key is placed at the same side as the teeth, unless specified otherwise.

We can make on request:

- wheels with machined teeth
- wheels with a different number of teeth
- special wheels

Pitch	Number of teeth	Dimensions (mm)						Weight (kg/p)
		Dp	De	d	D	Dm	L	
160	8	418,09	448	40	120	250	120	68
	10	517,77	554	40	120	250	120	90
	12	618,19	653	40	140	300	140	141
	16	820,12	860	40	140	300	140	177
200	8	522,62	552	40	120	250	120	91
	10	647,22	680	40	140	300	140	150
	12	772,74	807	40	140	300	140	165
	16	1025,16	1066	50	160	340	160	270
250	8	653,27	680	40	140	300	140	149
	10	809,02	843	40	140	300	140	173
	12	965,92	1003	50	160	340	160	239
	16	1281,45	1321	50	160	340	160	313
315	8	823,12	854	40	140	300	140	175
	10	1019,37	1053	50	160	340	160	255
	12	1217,06	1254	50	160	340	160	301
	16	1614,62	1654	50	180	360	180	436

CONNECTING LINKS

REF N° 208
Cottered connecting link

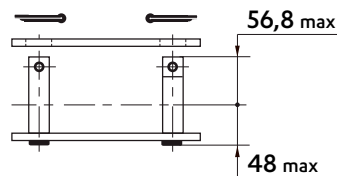

REF N° 209
Connecting link with self-locking nuts

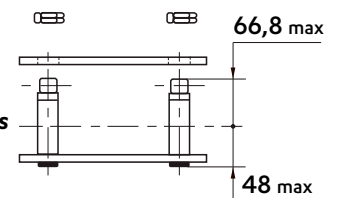
DRILLED PLATES

On outer and inner plates

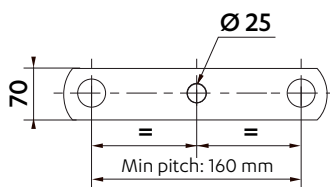

1 HOLE

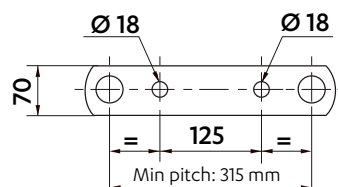

2 HOLES

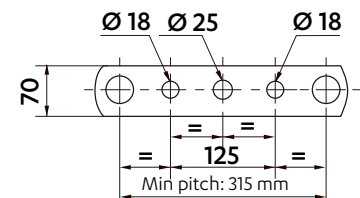

3 HOLES