

ISO STANDARD CHAINS 1977 - **M450**

Dimensions in mm

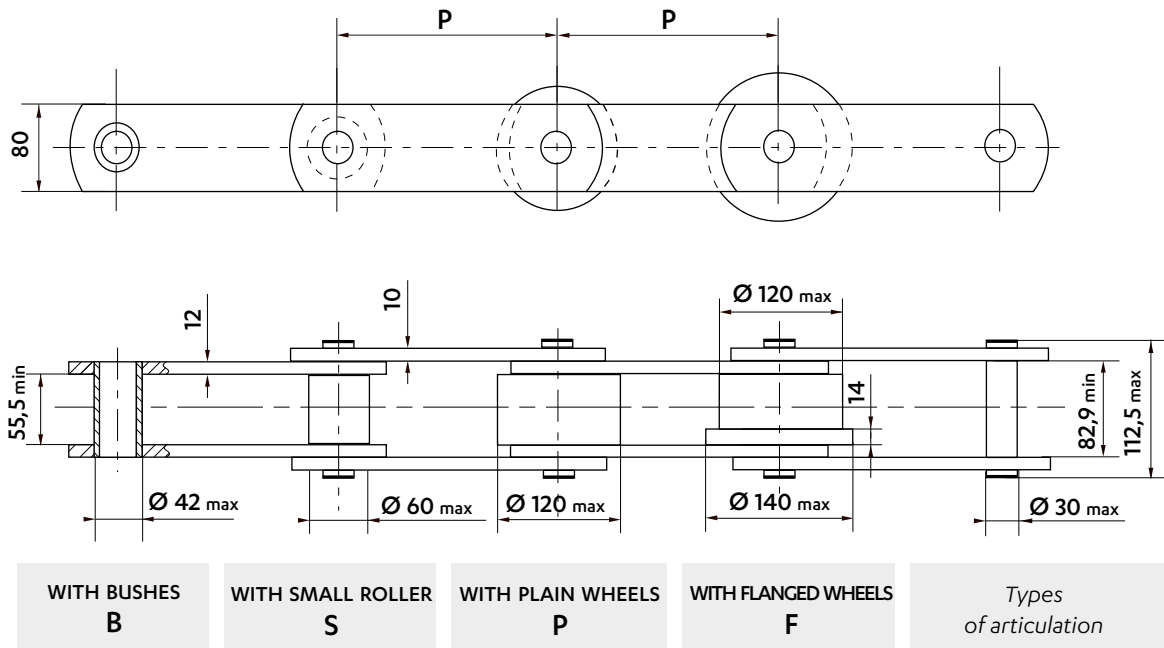

Wheels in different materials can be supplied.

WELDED K1 & K2 ATTACHMENTS - 80 X 80 X 8

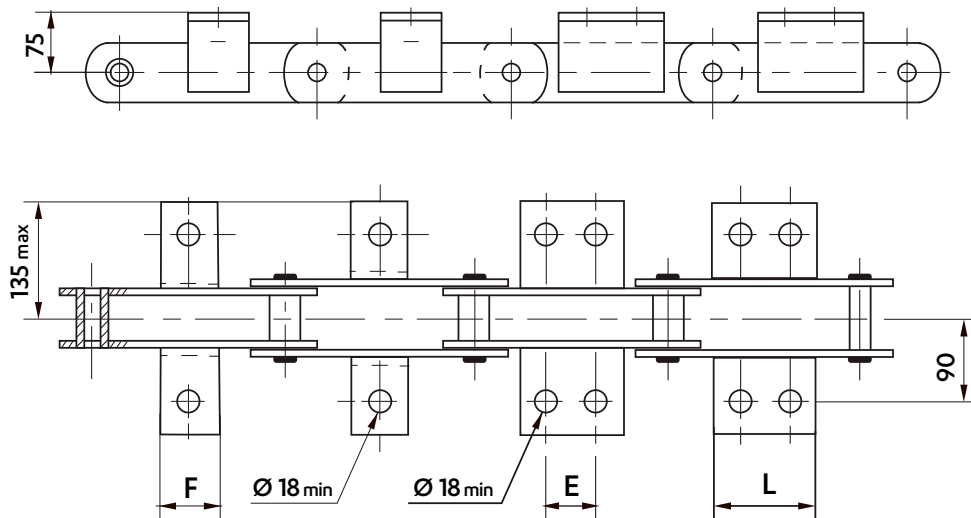

Frequency of attachments on request : on one or both sides of the chain, on inner and/or outer links

Pitch	Attachment dimensions (mm)						Weight of the chain (Kg/m)				Weight of the attachment (Kg/piece)			
	K1 F	K2C E	K2M L	K2M E	K2L L	K2L E	Bush (B)	Roller (S)	Plain wheel (P)	Flanged wheel (F)	K1	K2C	K2M	K2L
200	60	♦	♦	♦			22,2	25,3	43,9	47,4				
250	60	85	135	♦	♦		20,6	23,6	41,6	45,1				
315	60	85	135	155	205	♦	19,1	22,1	40,1	43,6	0,62	1,33	1,94	2,77
400	60	85	135	155	205	240	17,9	21,0	39,0	42,4				
500	60	85	135	155	205	240	17,2	20,3	38,2	41,7				
630	60	85	135	155	205	240	16,4	19,3	35,8	38,7				

♦ Not standard : possible to make on request.

Intermediate pitches are on request

Dimensions in mm

**WELDED G ATTACHMENTS**

Pitch	l3	b2	b14	l2	d11	e	h5	Weight (kg/p)
200	100			55				1,70
250	120	180	140	70	15	10	80	2,04
315	150			100				2,56

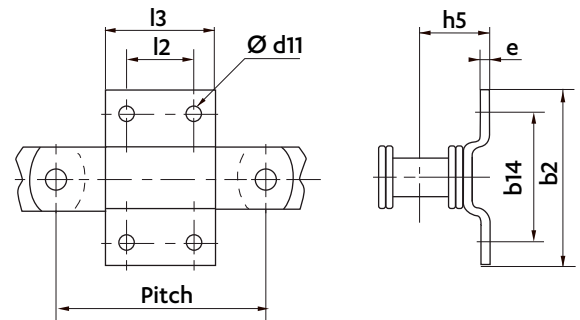
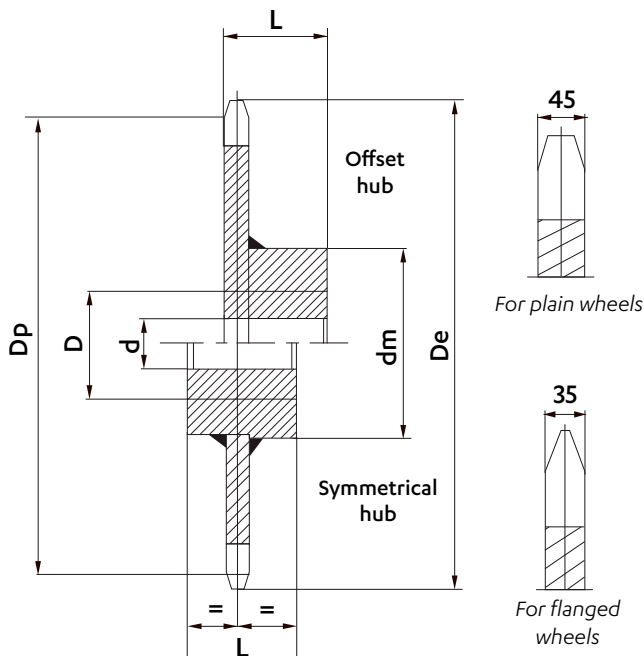
**STANDARD CHAIN WHEELS**

Sedis wheels are supplied made of machine-welded steel or of cast iron in some cases. Teeth are raw casting or flame-cut, or machined for bush chains. Wheels can be supplied bored and keyed. For wheels with offset hub, the entry point of the key is placed at the same side as the teeth, unless specified otherwise.

We can make on request:

- wheels with machined teeth
- wheels with a different number of teeth
- special wheels

Pitch	Number of teeth	Dimensions (mm)						Weight (kg/p)
		Dp	De	d	D	Dm	L	
200	8	522,62	559	40	140	280	140	120
	10	647,22	686	50	160	320	160	185
	12	772,74	800	50	160	320	160	259
	16	1025,16	1060	50	180	380	180	338
250	8	653,27	689	50	160	320	160	193
	10	809,02	848	50	160	320	160	250
	12	965,92	987	50	180	380	180	323
	16	1281,45	1311	50	180	380	180	429
315	8	823,12	815	50	160	320	160	269
	10	1019,37	1059	50	180	380	180	334
	12	1217,06	1229	50	180	380	180	412
	16	1614,62	1638	60	200	460	200	757
400	8	823,12	1020	50	180	380	180	352
	10	1019,37	1334	50	180	380	180	526
	12	1217,06	1547	60	200	460	200	630

**CONNECTING LINKS**

REF N° 208  
Cottered connecting link

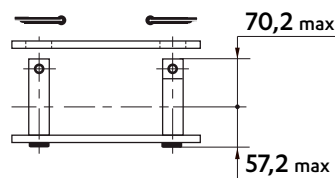

REF N° 209  
Connecting link with self-locking nuts

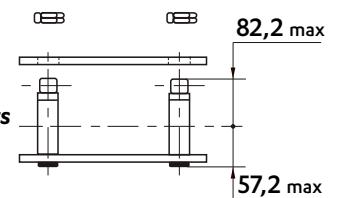
**DRILLED PLATES**

On outer and inner plates

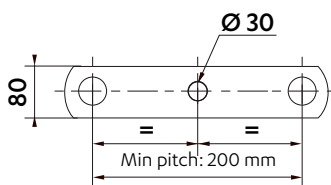
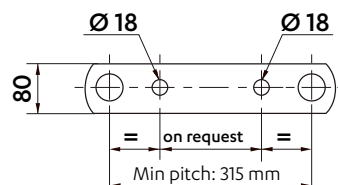
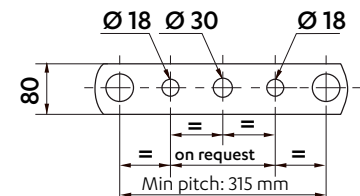
**1 HOLE**

**2 HOLES**

**3 HOLES**