

ISO STANDARD CHAINS 1977 - M630

Dimensions in mm

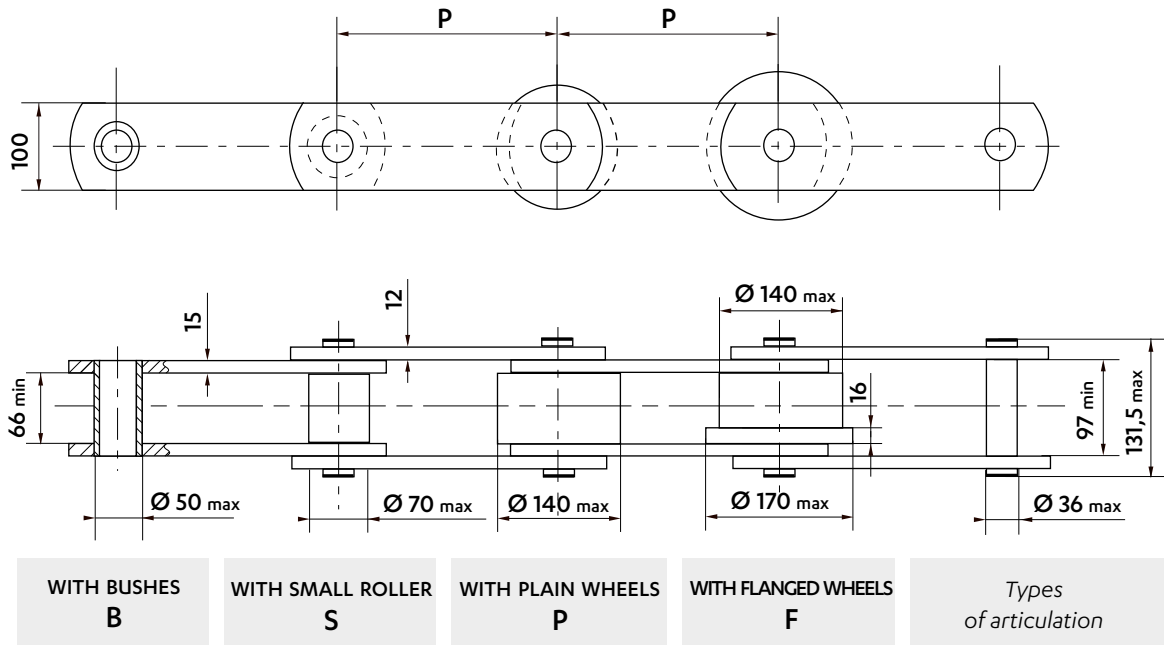

Wheels in different materials can be supplied.

WELDED K1 & K2 ATTACHMENTS - 100 X 100 X 12

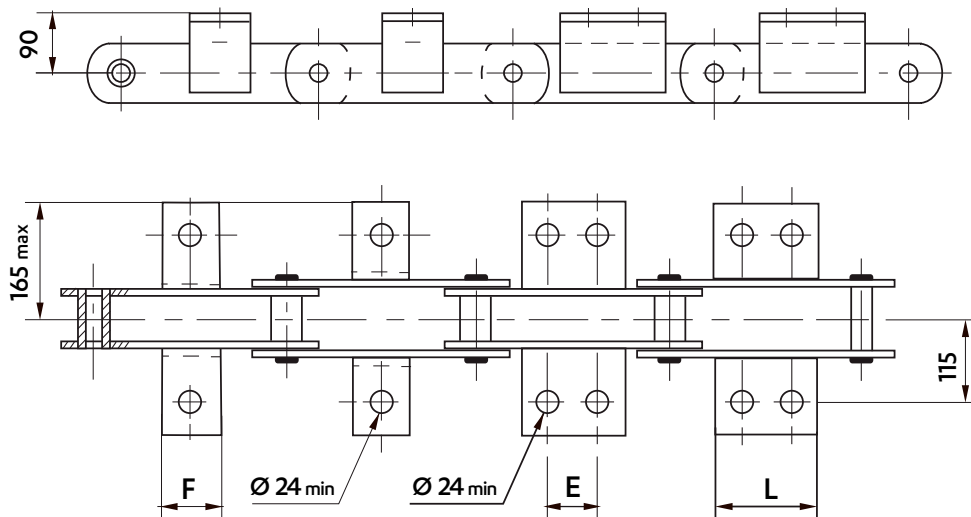

Frequency of attachments on request : on one or both sides of the chain, on inner and/or outer links

Pitch	Attachment dimensions (mm)							Weight of the chain (Kg/m)				Weight of the attachment (Kg/piece)				
	K1		K2C		K2M		K2L		Bush (B)	Roller (S)	Plain wheel (P)	Flanged wheel (F)	K1	K2C	K2M	K2L
	F	E	L	E	L	E	L									
250	50	♦		♦		♦		34,9	39,2	60,5	65,6					
315	50	100	150	♦		♦		32,3	35,5	52,6	56,4					
400	50	100	150	190	240	♦		30,1	32,5	46,1	49,3	0,9	2,68	4,28	6,25	
500	50	100	150	190	240	300	350	28,5	30,3	41,2	43,7					
630	50	100	150	190	240	300	350	27,2	28,6	37,2	39,2					

♦ Not standard : possible to make on request.

Intermediate pitches are on request

Dimensions in mm

WELDED G ATTACHMENTS

Pitch	l3	b2	b14	l2	d11	e	h5	Weight (kg/p)
250	130			75	19			3,71
315	170	260	200	100		12	96	4,85

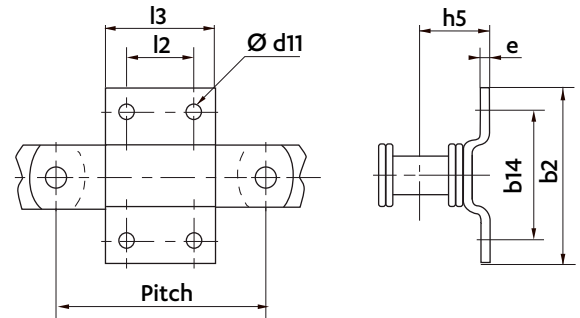
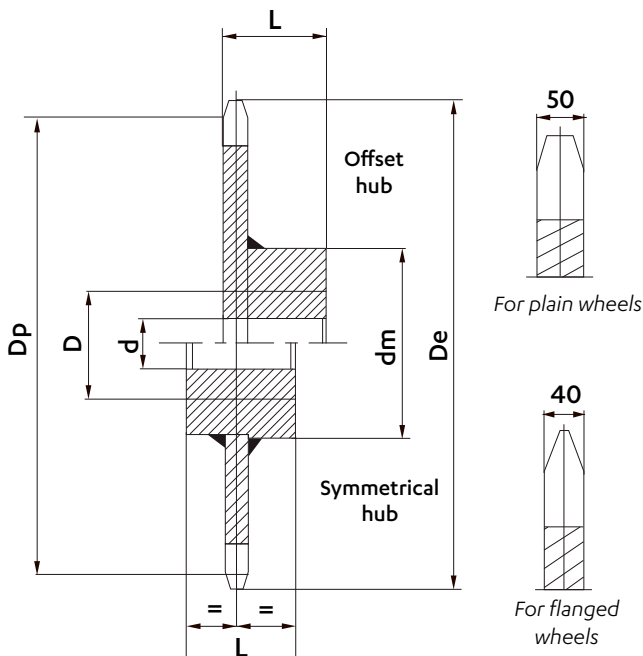
STANDARD CHAIN WHEELS

Sedis wheels are supplied made of machine-welded steel or of cast iron in some cases. Teeth are raw casting or flame-cut, or machined for bush chains. Wheels can be supplied bored and keyed. For wheels with offset hub, the entry point of the key is placed at the same side as the teeth, unless specified otherwise.

- We can make on request:
- wheels with machined teeth
 - wheels with a different number of teeth
 - special wheels

Pitch	Number of teeth	Dimensions (mm)						Weight (kg/p)
		Dp	De	d	D	Dm	L	
250	8	653,27	693	50	160	320	160	175
	10	809,02	849	50	160	320	160	240
	12	965,92	1006	50	180	380	180	352
	16	1281,45	1321	50	180	380	180	556
315	8	823,12	863	50	160	320	160	246
	10	1019,37	1059	50	180	380	180	383
	12	1217,06	1257	50	180	380	180	510
400	16	1614,62	1654	50	200	460	200	890
	8	1045,24	1085	50	180	380	180	398
	10	1294,44	1334	50	180	380	180	565
	12	1545,48	1585	50	200	460	200	228

CONNECTING LINKS

REF N° 208
Cottered connecting link

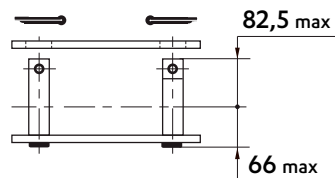

REF N° 209
Connecting link with self-locking nuts

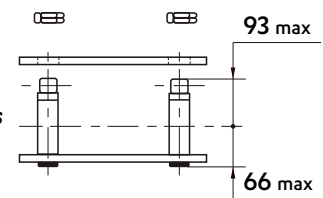
DRILLED PLATES

On outer and inner plates

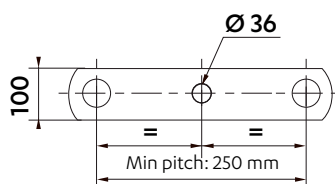
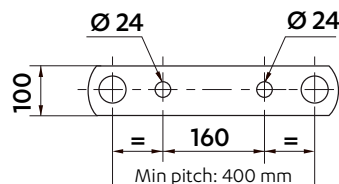
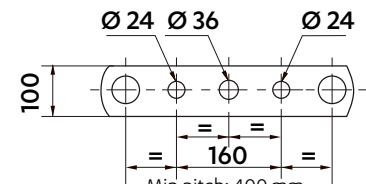
1 HOLE

2 HOLES

3 HOLES